



One Drawer Washing Machine Stand

IMPORTANT

Before Commencing Assembly:

- Read all instructions **COMPLETELY**
- Ensure all listed parts are present
If any parts are missing from Parts List 1, please contact 1800 822 823.
If any parts are missing from Parts List 2&3, please contact 1300 559 387.
- Ensure you have the required tools to complete the assembly
(*Phillips Head Screwdriver, Hammer & Spirit Level*)

CAUTION

- Ensure your work surface is solid, level, clean and flat (**DO NOT WORK ON CARPET**)
- Ensure ALL melamine edges are facing as described in the Assembly Instructions.

IF YOU HAVE NEED TO CONTACT US WITH REGARD TO THIS PRODUCT PLEASE CALL **1800 822 823** AND QUOTE THE BATCH NUMBER SHOWN ON THE CARTON.

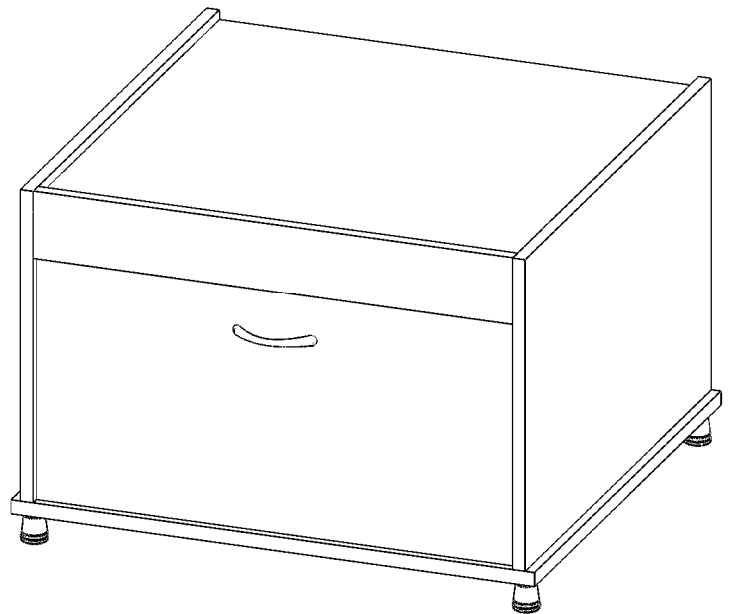

615 Goodwood Road, Panorama SA 5041
PO Box 18 Melrose Park SA 5039
Telephone: 1800 822 823, Fax: (08) 8460 0009
Email: furniture@bedfordgroup.com.au
www.bedfordgroup.com.au



Quality
Endorsed
Company
ISO 9001 Lic#EC0796
SAI Global



AUSTRALIAN MADE

Practical, Adaptable, Affordable.

READY TO ASSEMBLE HOME STORAGE SOLUTIONS

Parts List 1

One Drawer Washing Machine Stand

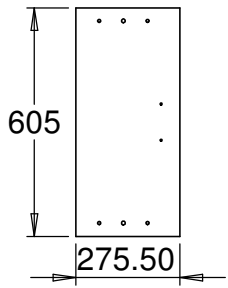

Part No.	Description	Qty.
1	Drawer Front	1

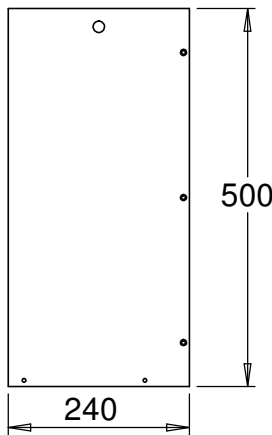

Part No.	Description	Qty.
2	Drawer Left Side	1

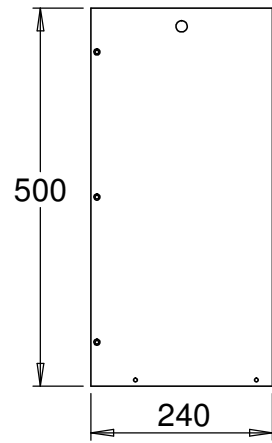

Part No.	Description	Qty.
3	Drawer Right Side	1

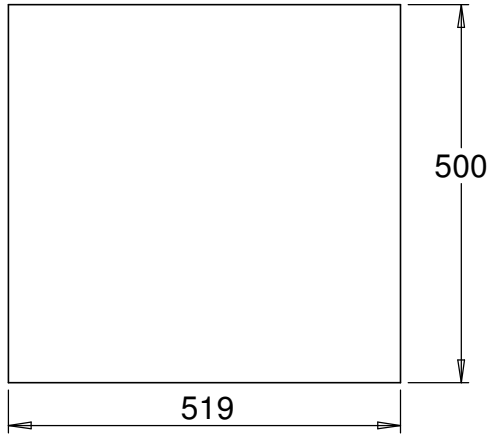

Part No.	Description	Qty.
4	Drawer Bottom	1

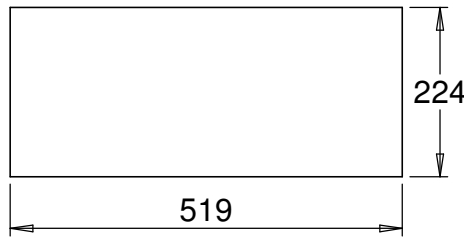

Part No.	Description	Qty.
5	Drawer Back	2

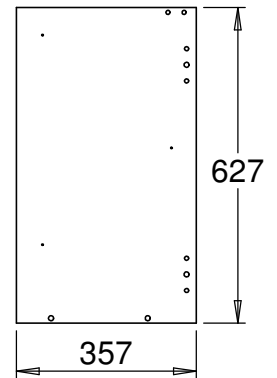

Part No.	Description	Qty.
6	Left Cabinet End	1

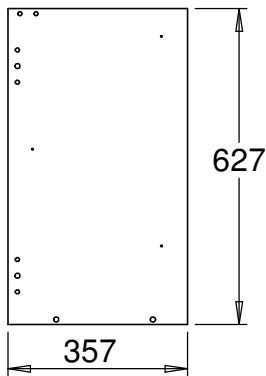

Part No.	Description	Qty.
7	Right Cabinet End	1

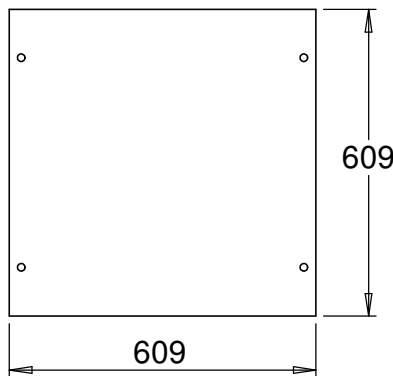

Part No.	Description	Qty.
8	Unit Top	1

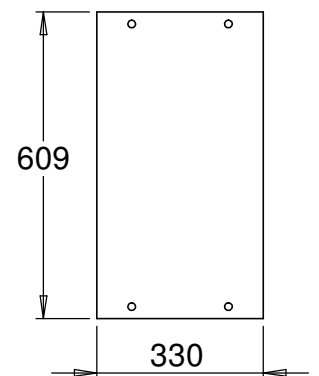

Part No.	Description	Qty.
9	Unit Back	1

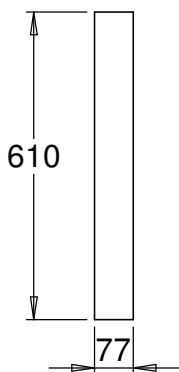

Part No.	Description	Qty.
10	Front Rail	1

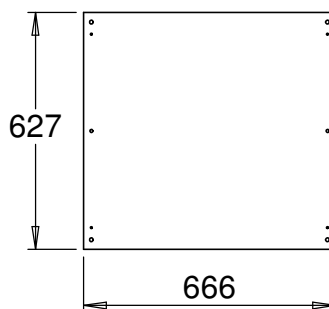

Part No.	Description	Qty.
11	Unit Bottom	1

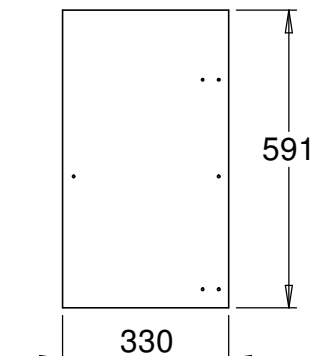

Part No.	Description	Qty.
12	Support Panels	2

Parts List 2

One Drawer Washing Machine Stand

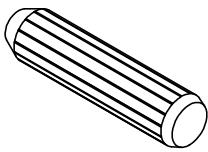

Part No.	Description	Qty.
13	Dowels	18

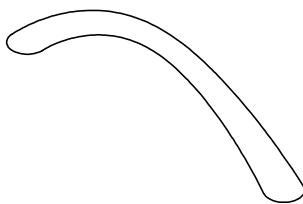

Part No.	Description	Qty.
14	Handle	1

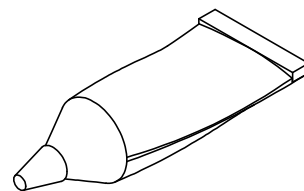

Part No.	Description	Qty.
15	Glue Tube	1

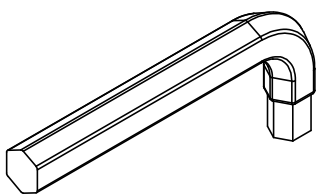

Part No.	Description	Qty.
16	Allen Key	1

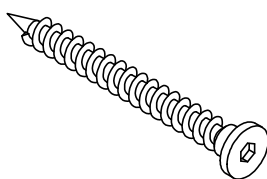

Part No.	Description	Qty.
17	45 mm Screw	14



Part No.	Description	Qty.
18	Screw Cams	10

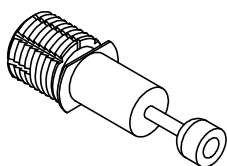

Part No.	Description	Qty.
19	Screw Cam Pins	10

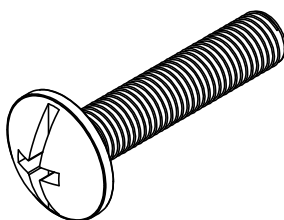

Part No.	Description	Qty.
20	Handle Screw	2

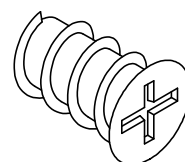

Part No.	Description	Qty.
21	Varianta Screw	6

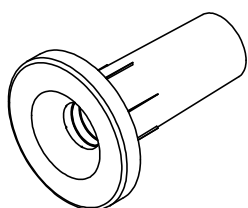

Part No.	Description	Qty.
22	Feet Socket	4

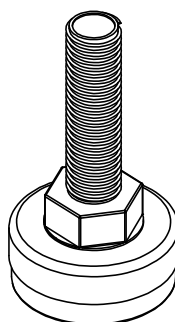

Part No.	Description	Qty.
23	Adjustable Glide	4

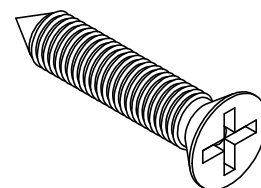

Part No.	Description	Qty.
24	20 mm Screw	6

Parts List 3

One Drawer Washing Machine Stand

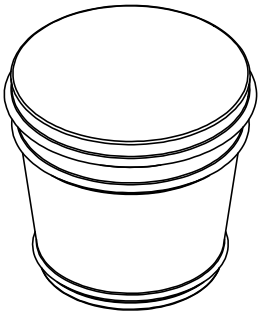

Part No.	Description	Qty.
25	Rubber Feet	4

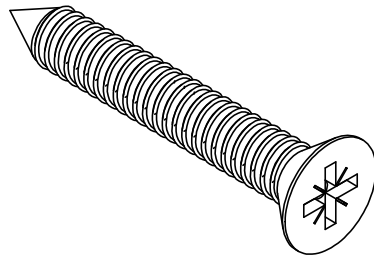

Part No.	Description	Qty.
26	25 mm Screw	4

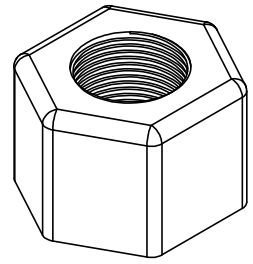

Part No.	Description	Qty.
27	Locking Nut	4



Part No.	Description	Qty.
32	Silicone Tube	1

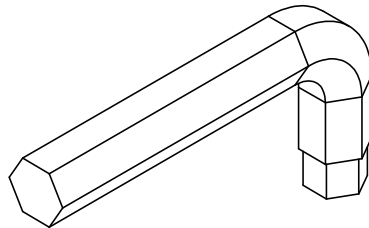

Part No.	Description	Qty.
33	Allen Key (4 mm)	1

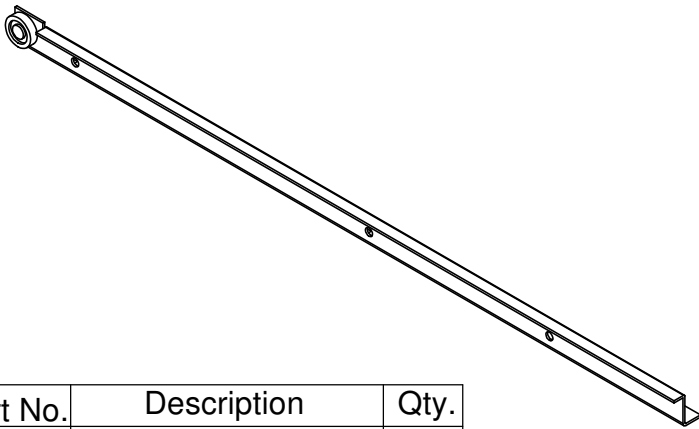

Part No.	Description	Qty.
28	Left Drawer Runner	1

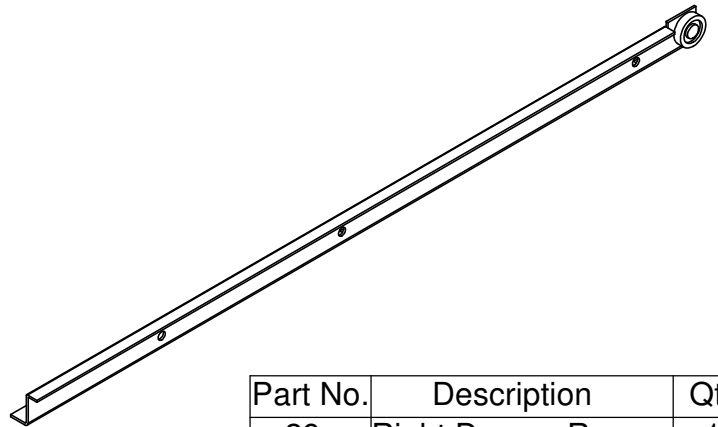

Part No.	Description	Qty.
29	Right Drawer Runner	1

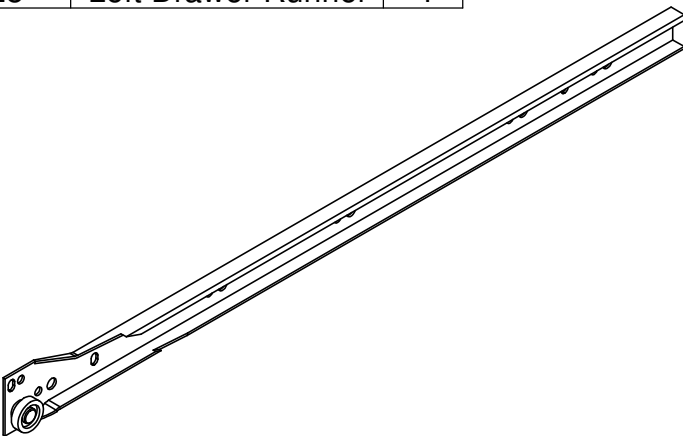

Part No.	Description	Qty.
30	Left Drawer Track	1

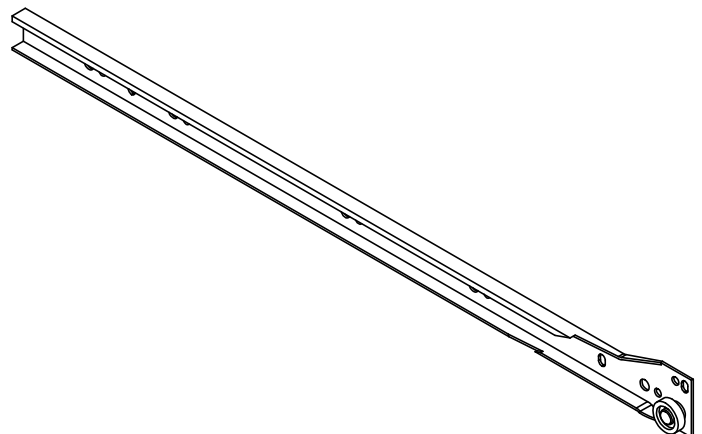

Part No.	Description	Qty.
31	Right Drawer Track	1

STEP 1

DRAWER FRONT

Lay Drawer Front (1) on a flat protected surface with holes facing up. Insert pins (19) into Drawer Front pushing firmly. Use Glue prior to inserting wooden dowels (13) into the holes (Please remove excess glue with a Damp cloth). Make sure to push the dowels (13) all the way in by gently tapping them in with hammer.

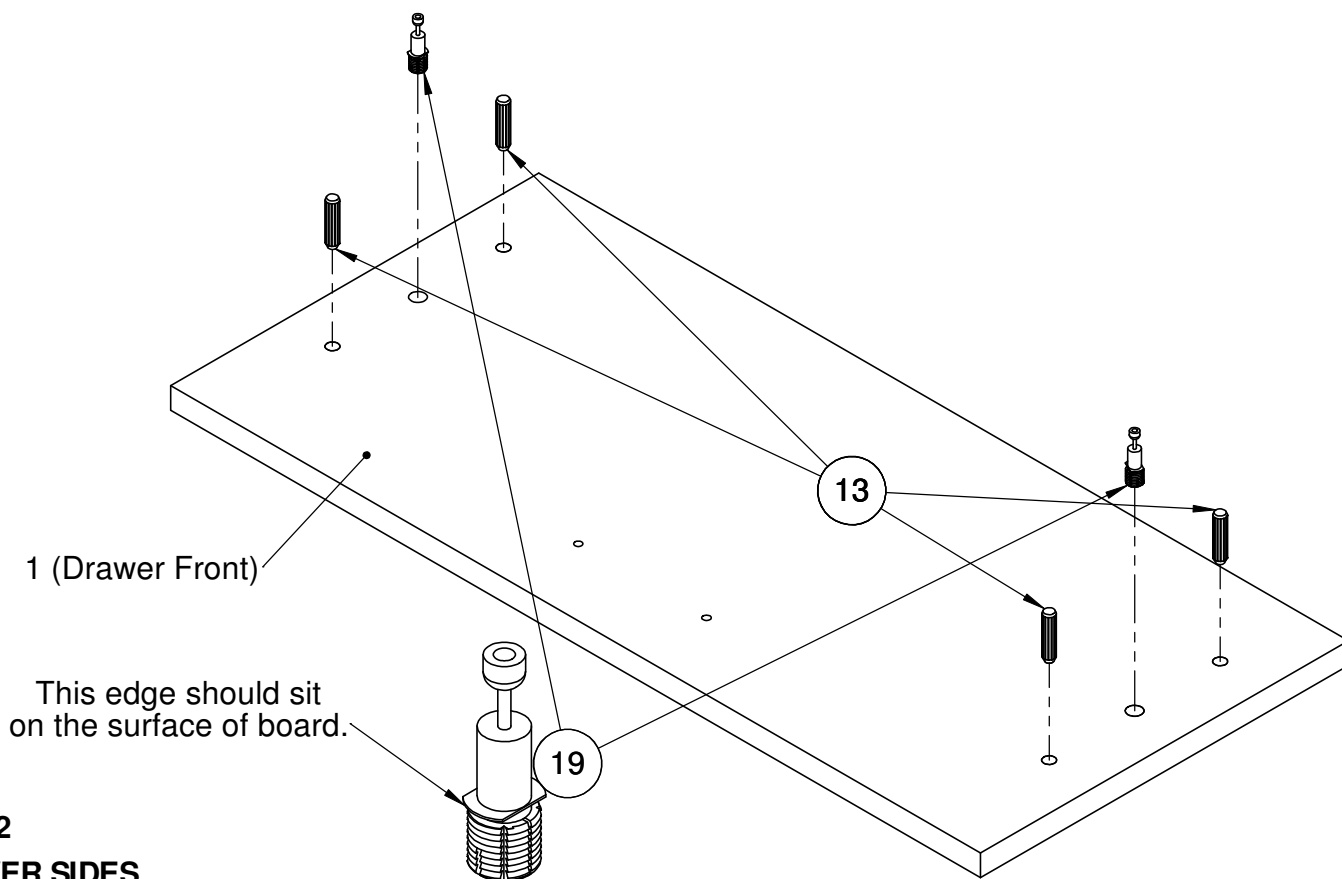

STEP 2

DRAWER SIDES

Lay the Drawer Sides (2) & (3) on a flat surface and insert the Cams in large holes with arrows pointing to the front of Drawer Side. Make sure to push the cams (18) all the way in by gently tapping them with hammer. Insert small amount of glue in the dowel holes as shown in picture.

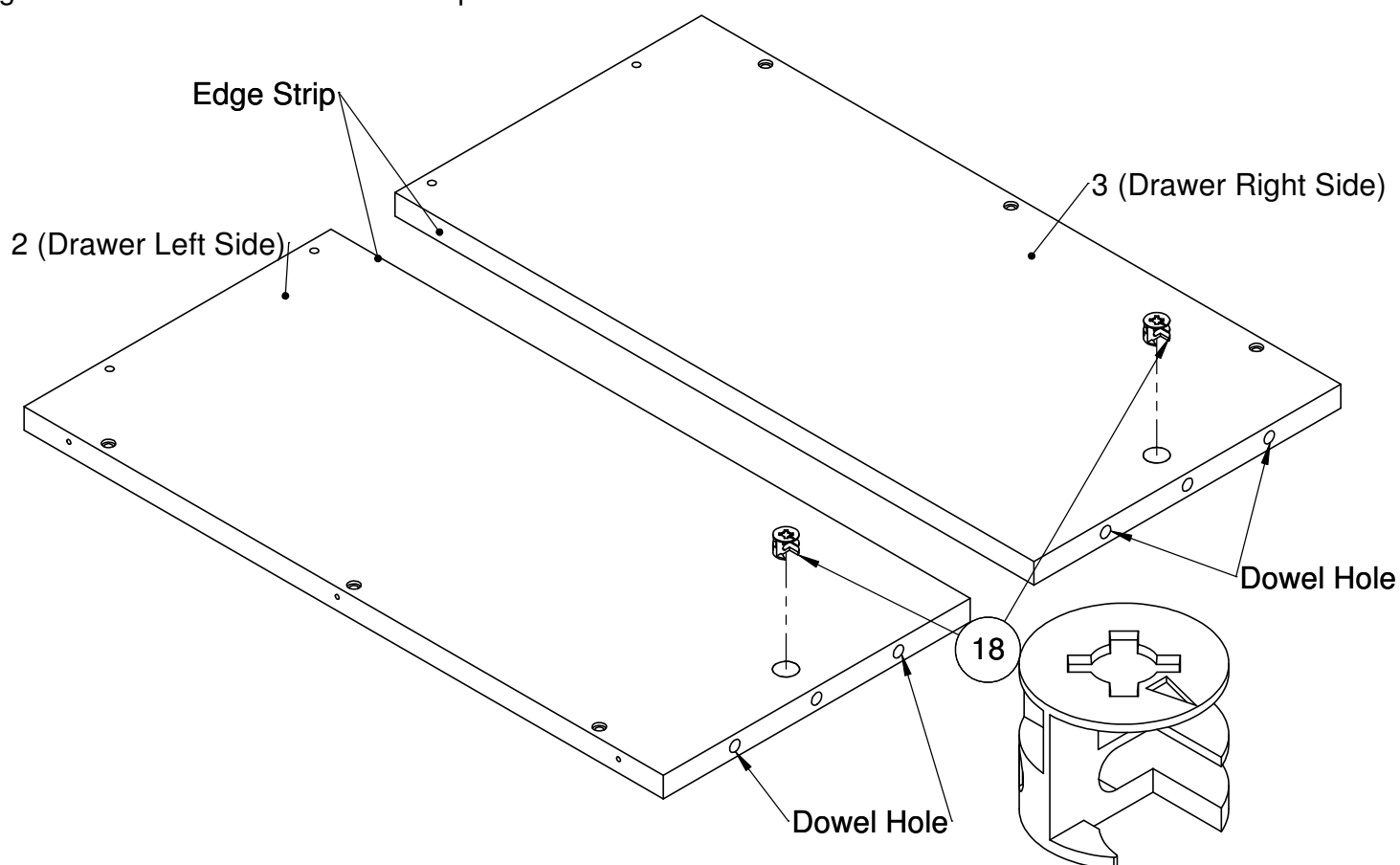

STEP 3

DRAWER FRONT & DRAWER SIDES

Ensuring that all Holes line up, firmly push the Drawer Sides (2) & (3) into the Drawer Front (1) ensuring that the long edge strip on drawer side faces toward the top of drawer front as well as the large hole is facing toward the front and outside of the drawer. Lock in place by rotating the Cam (18) in the clockwise direction, using Allen Key (33) so that, the arrows face toward back of drawer.

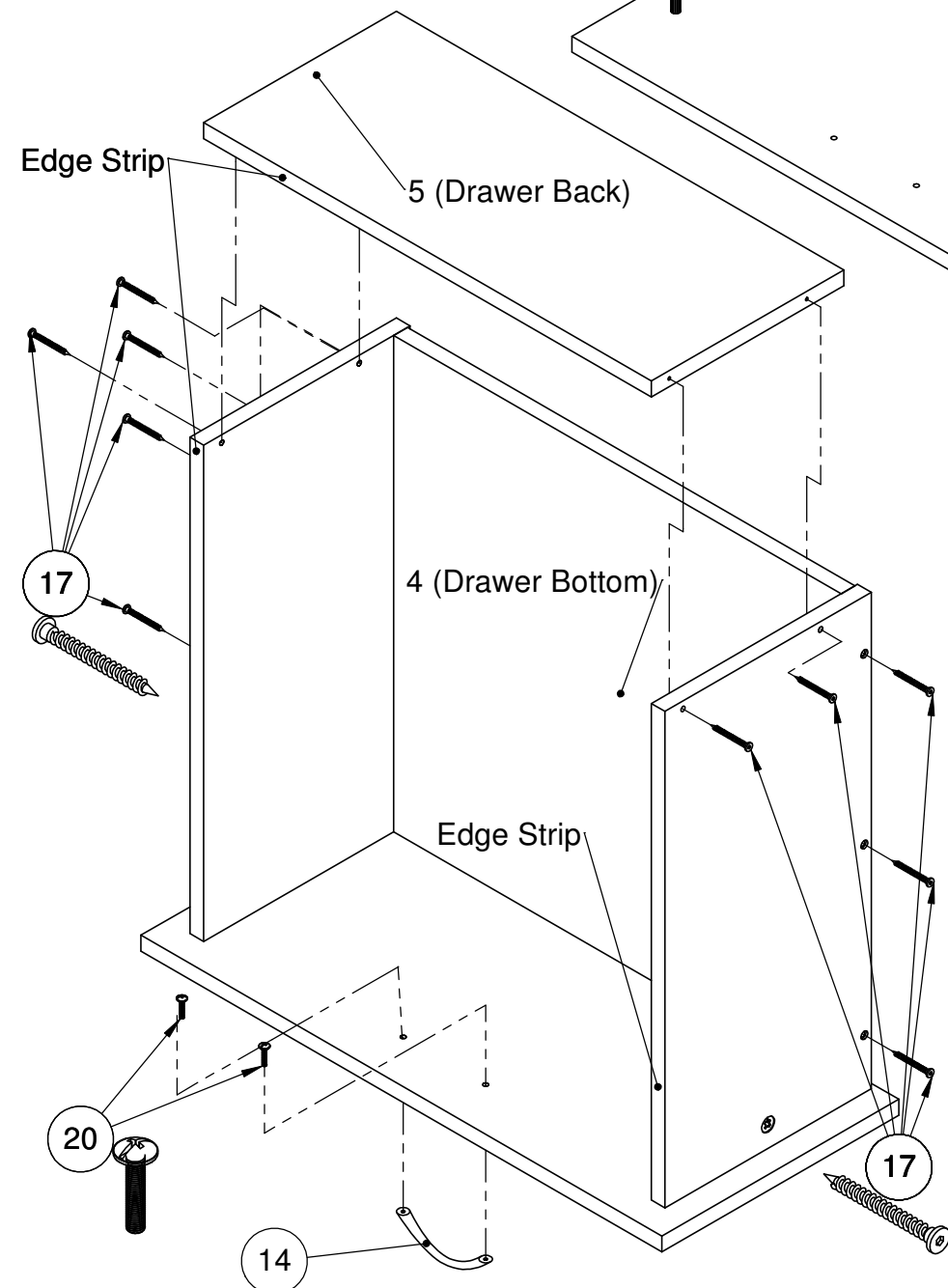
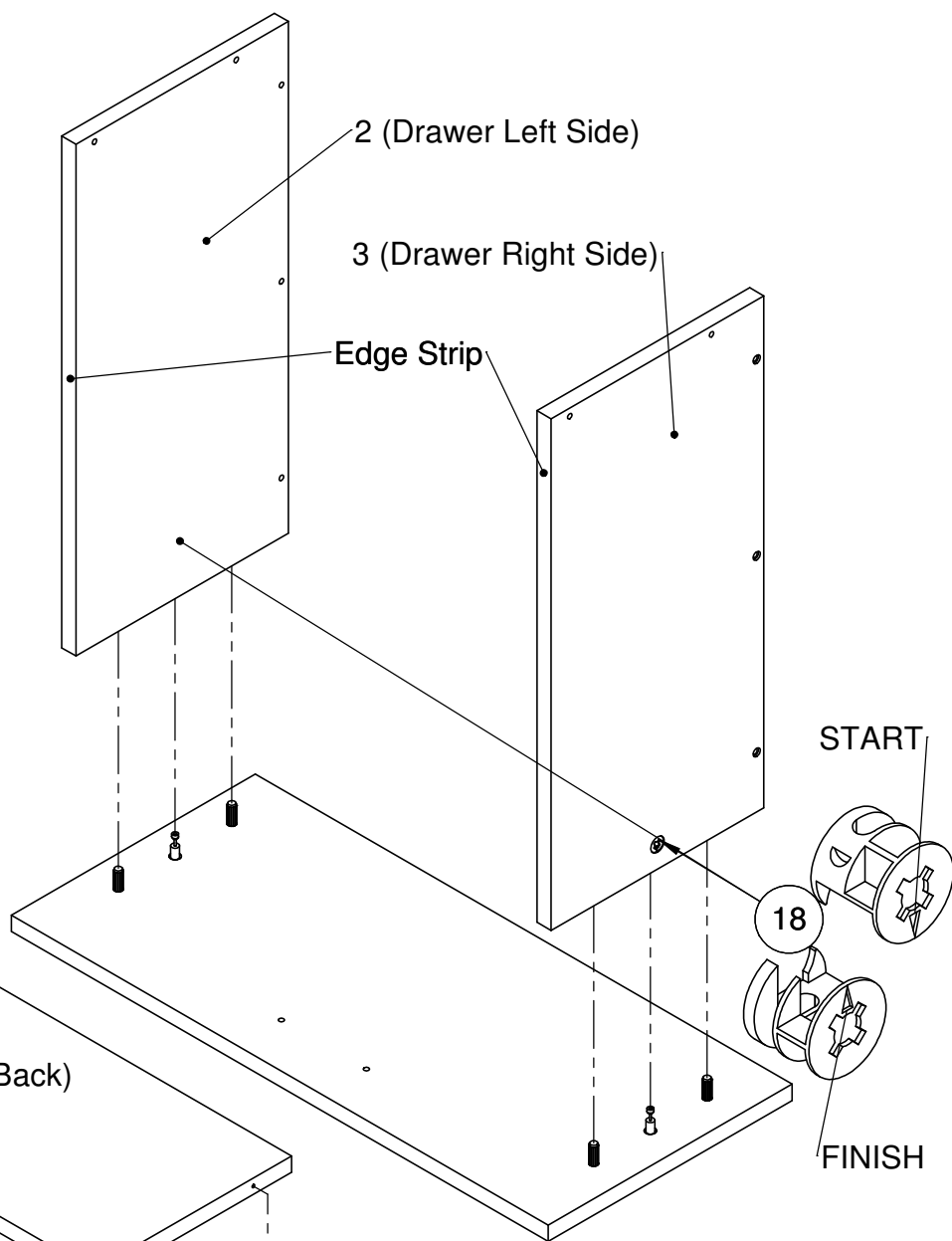

STEP 4

COMPLETE DRAWER WITHOUT DRAWER RUNNERS

Position the drawer bottom (4) aligned with the holes of drawer sides (2) & (3) and making sure that the drawer bottom (4) is pressed up along the drawer front (1), fix it using screws (17) with the help of Allen Key (16). Insert the drawer back (5) between drawer sides (2) & (3) with long edge strip facing toward the top of drawer front (1) and align it with the holes in drawer side and lock in position using screws (17). Lay down the drawer flat with bottom facing down on protected surface and fix the handle (14) using screws (20).

STEP 5

COMPLETE DRAWER WITH DRAWER RUNNERS

Lay down the drawer with bottom facing up and align the Drawer Runner (28) along the bottom edge of the drawer side (2). Hold the drawer runner tightly in position and fix it with 20 mm screws (24) using the pilot holes provided on the bottom edge of drawer side. Repeat this step to fix the RH Drawer Runner (29) with drawer side (3).

Note:

To help with identification, the left hand Drawer Runner is imprinted with letters "DL" whilst the right hand Drawer Runner is imprinted with "DR".

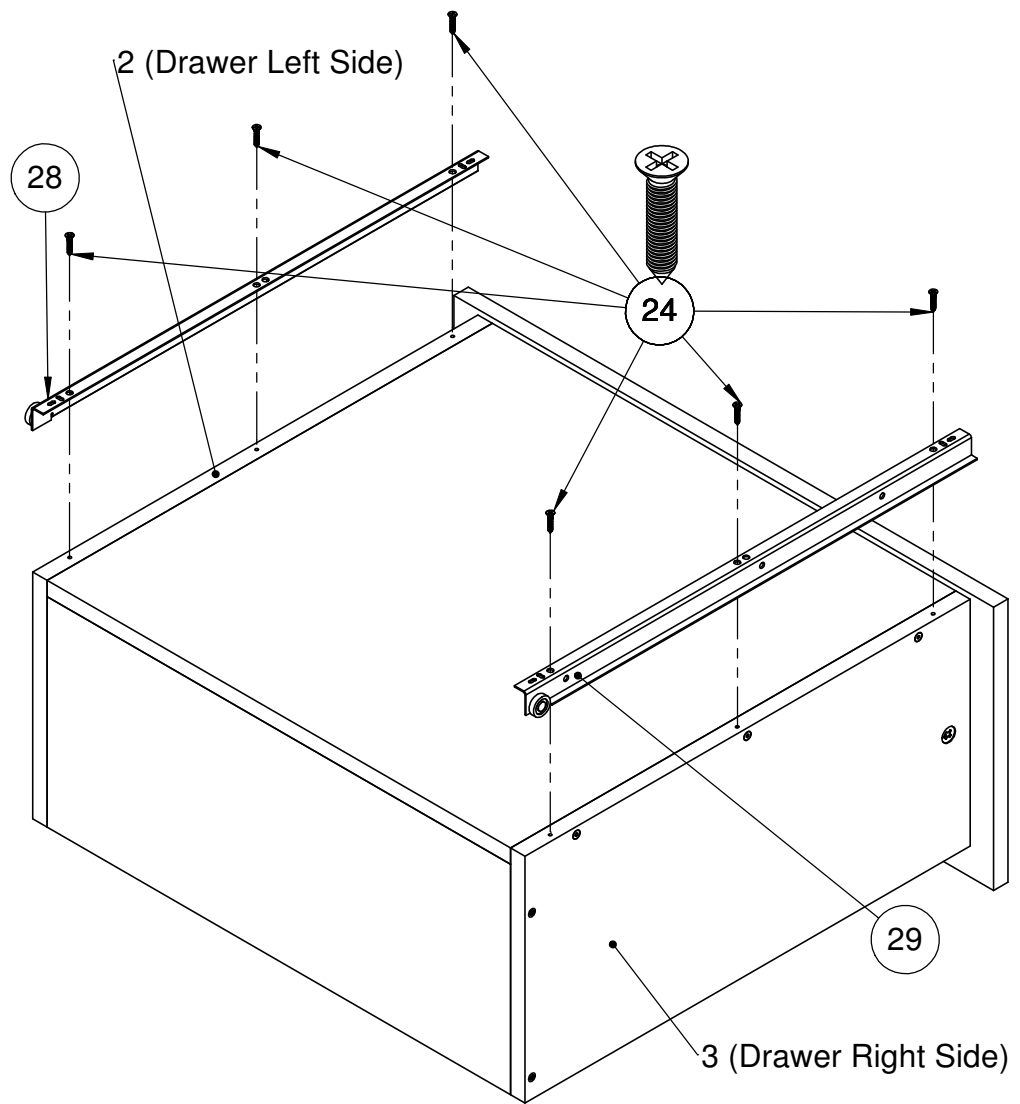

STEP 6

CABINET END LEFT HAND

Lay down Cabinet End Left Hand (6) on a flat protected surface and assemble it as shown in picture.

Please use glue prior to inserting the dowels (13) in the holes and tap gently with hammer (Please remove excess glue with a Damp cloth). Push the pins (19) down firmly all the way in and make sure that they sit in properly. Repeat this step to assemble the Cabinet End Right Hand (7).

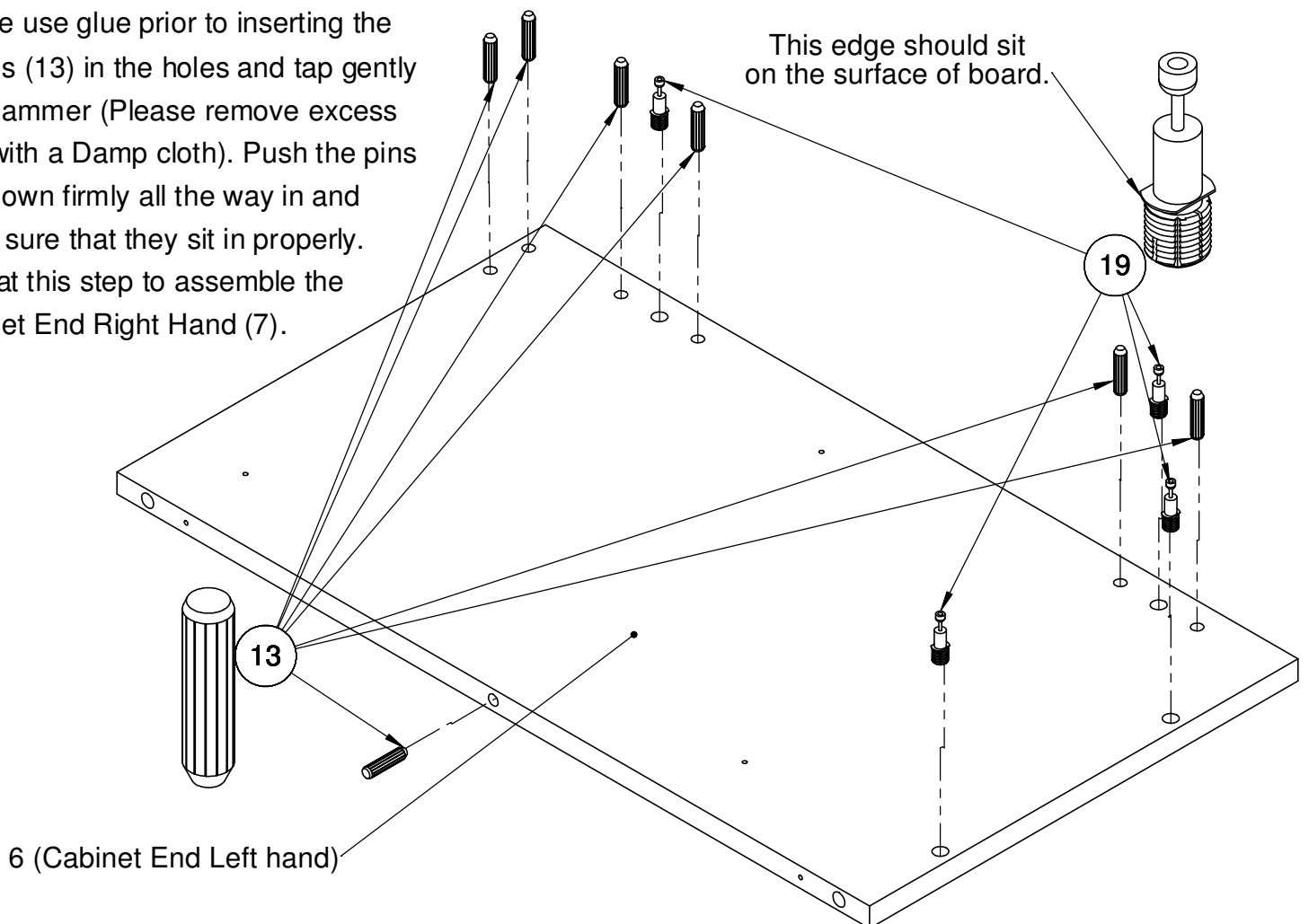

STEP 7

UNIT BACK & TOP

Lay down the Unit Back (9) and Unit Top (8) on flat Surface with holes facing up and insert the Cams (18) in the holes. Please make sure that the arrows face toward the outer edge as shown in the picture.

STEP 8

ENDS, BACK, BOTTOM & FRONT RAIL ASSEMBLY

Fix the Unit Back (9) with the assembled cabinet end left hand by inserting the pins into cam holes and locking them in by rotating the cams clockwise 180° . Assemble the unit top (8) with the assembled cabinet end left hand making sure that the long edge strip faces the back of unit. Lock the top in position by rotating the Cams (18) 180° . Now, insert the Front Rail with 2mm edge strip facing toward the top of the unit into the dowels. Please use glue in all the dowel holes prior to inserting and clean excessive glue with a damp cloth.

Join the assembled cabinet end right hand with the above assembly and lock the cams by turning clockwise 180° .

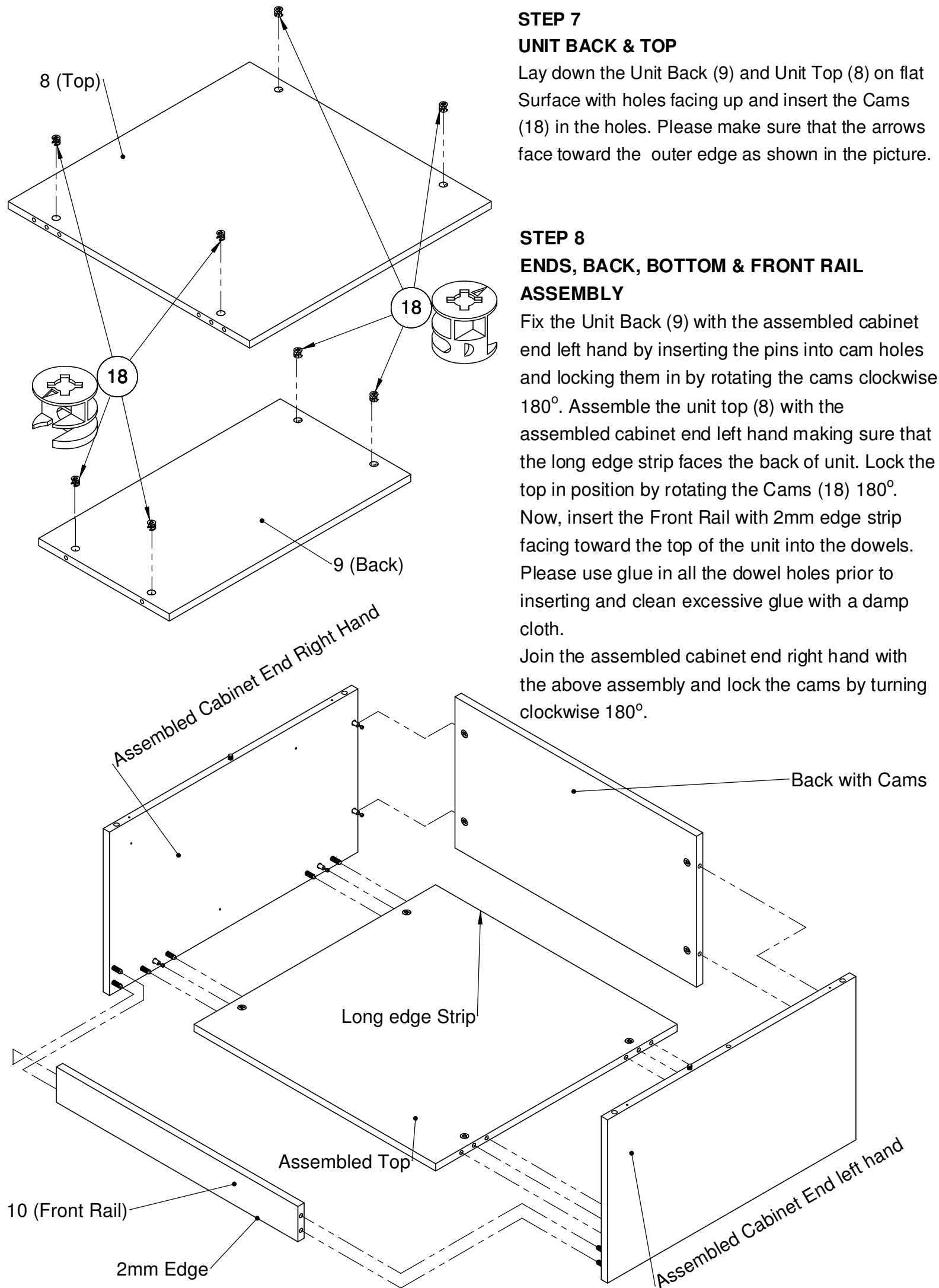

STEP 9

MOUNTING DRAWER TRACKS on INTERNAL SUPPORT PANELS

Lay down the internal support panels (12) on a flat protected surface and mount the drawer tracks (30) and (31) as shown using screws (21). Take care to set the front of the Drawer tracks up 2mm from the edge of Panel.

Note:

To help with Identification, the Left hand Drawer Track is imprinted with letter "CL" whilst the Right Hand Drawer Track is imprinted with "CR".

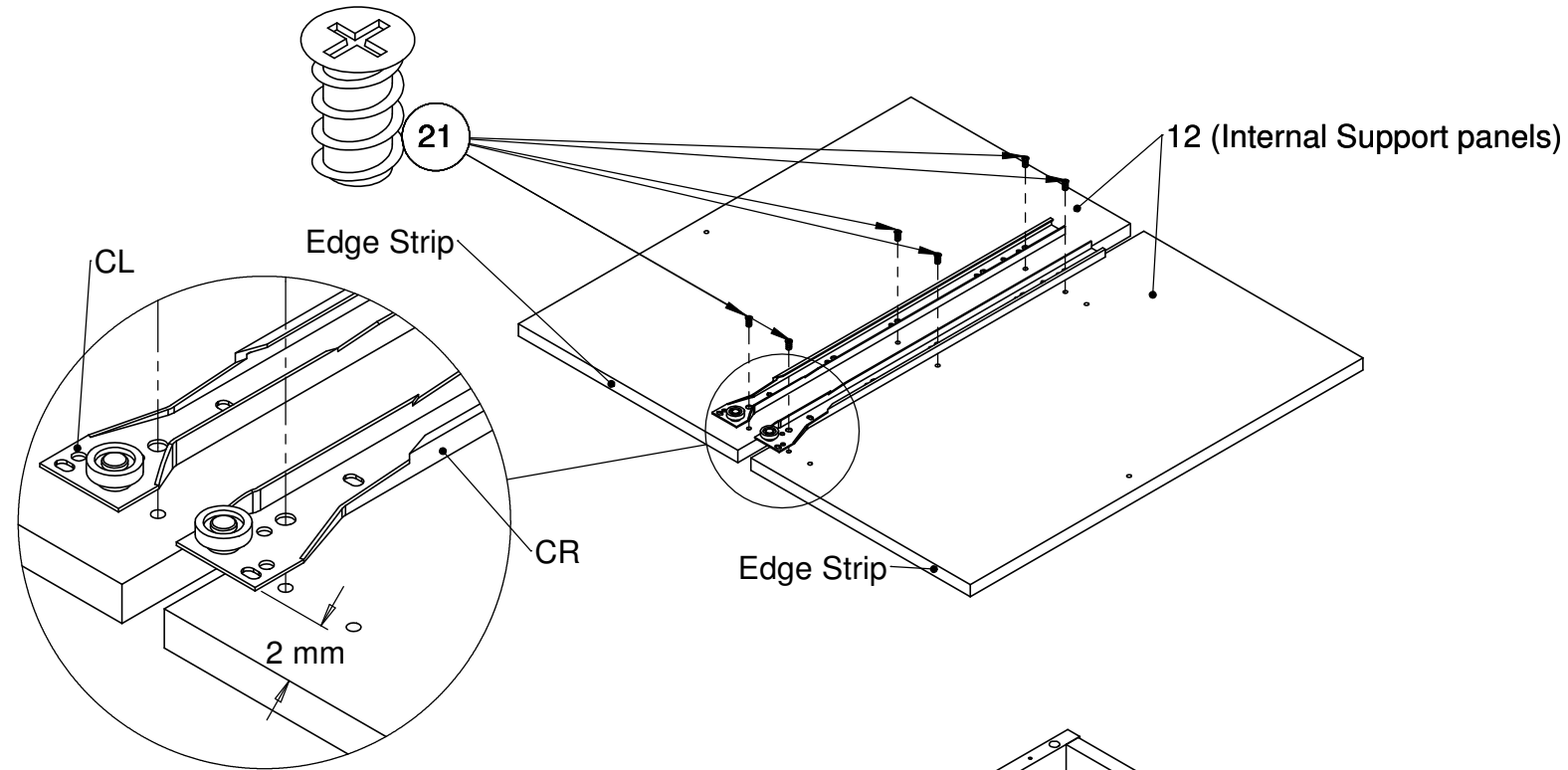

STEP 10

ASSEMBLING INTERNAL SUPPORT PANELS WITH CABINET ENDS

Fix the internal support panel containing right hand drawer track on the right cabinet end and left drawer track on left end using screws (26).

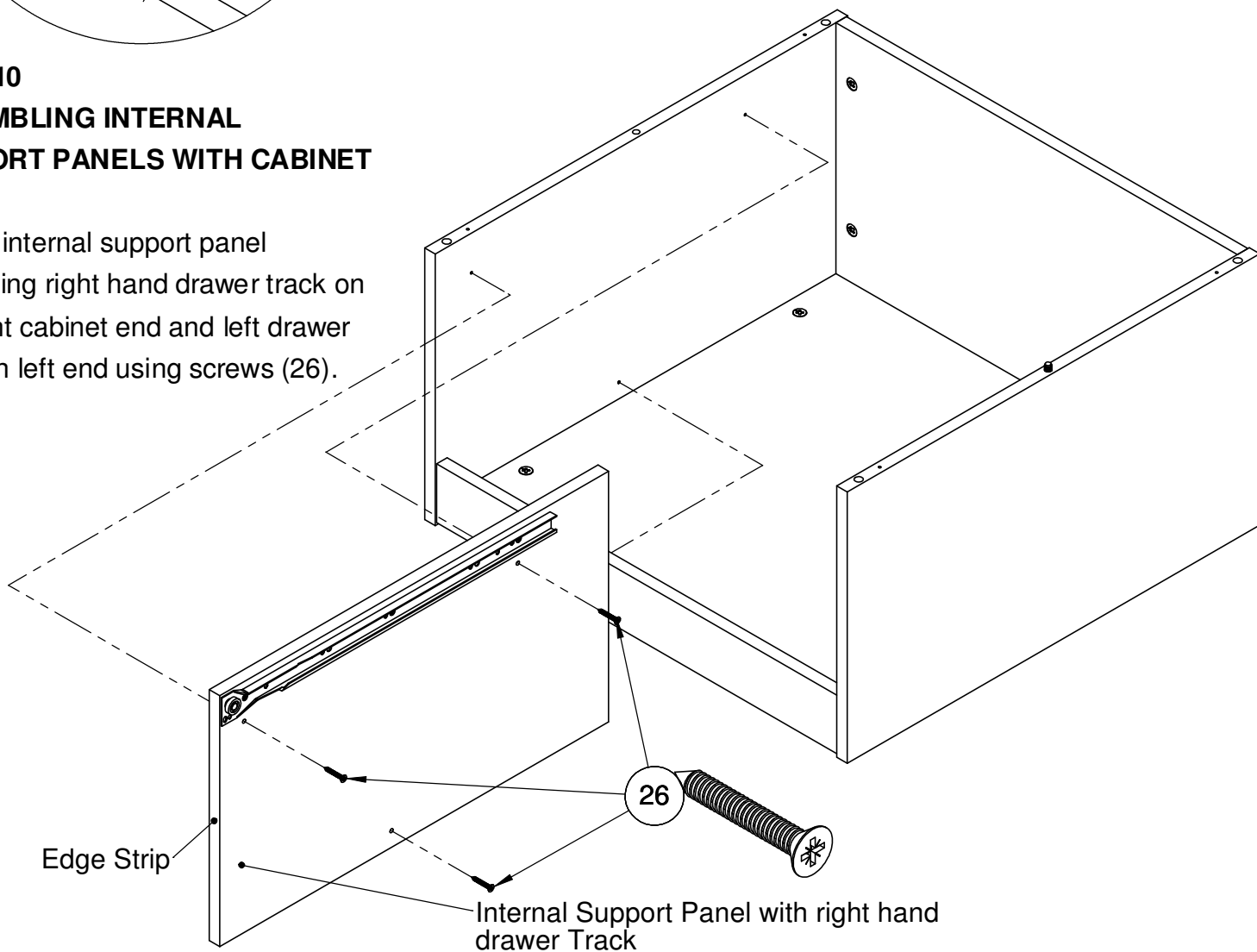

STEP 11 UNIT BOTTOM

Carefully place the Unit bottom (11) on the cabinet ends and align the dowels in the cabinet ends with the dowel holes in the bottom and press the unit bottom down. Now, align the feet socket holes in unit bottom (11) with the feet socket holes in cabinet ends and gently hammer in the feet sockets (22).

Caution

Please make sure that holes align up before hammering the feet sockets otherwise they may break through the sides of the cabinet ends.

Now, fix the unit bottom (11) with ends using screws (17).

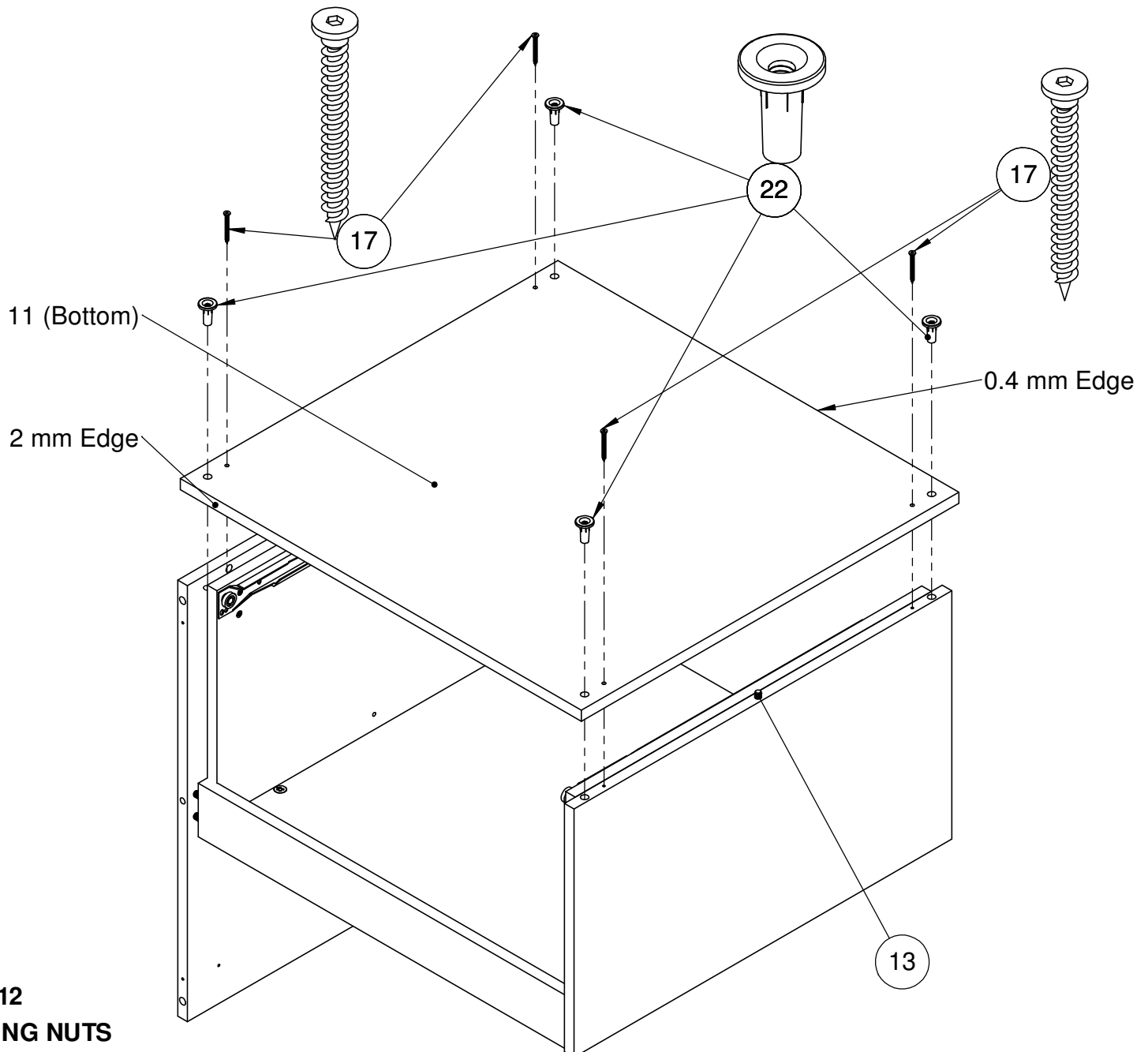

STEP 12 LOCKING NUTS

Please put the locking nuts (27) on the adjustable feet glides (23) and loosely screw them in feet sockets (22).

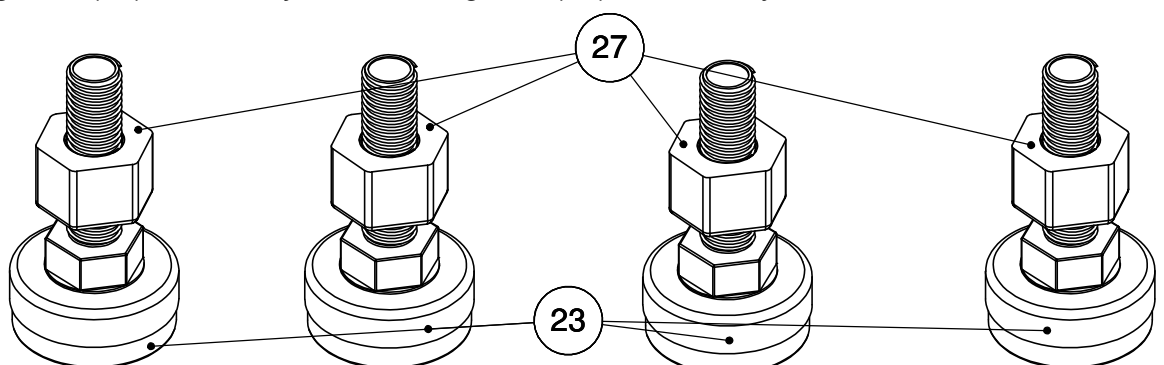

STEP 13
ALIGNMENT OF UNIT AND RUBBER FEET

CAUTION:

Lifting by two persons recommended
Requires spirit level for alignment

Please Invert the unit and place it straight on the floor. Adjust the alignment of unit by adjusting the adjustable feet glides (23). Once adjusted, please use spirit level on top of the unit to confirm the alignment of the unit.

Once all the feets are aligned, please lock them in by tightening the locking nut (27) against the feet socket (22). After making sure that whole unit is aligned, carefully lift the end of unit one by one and put on rubber feet (25).

Insert the Drawer in and the unit is ready to use.

Once the Stand is in place and level, also ensure the washing machine or dryer that sits on the stand is also level.

Refer to the manufacturer's instructions for information on how to do this.

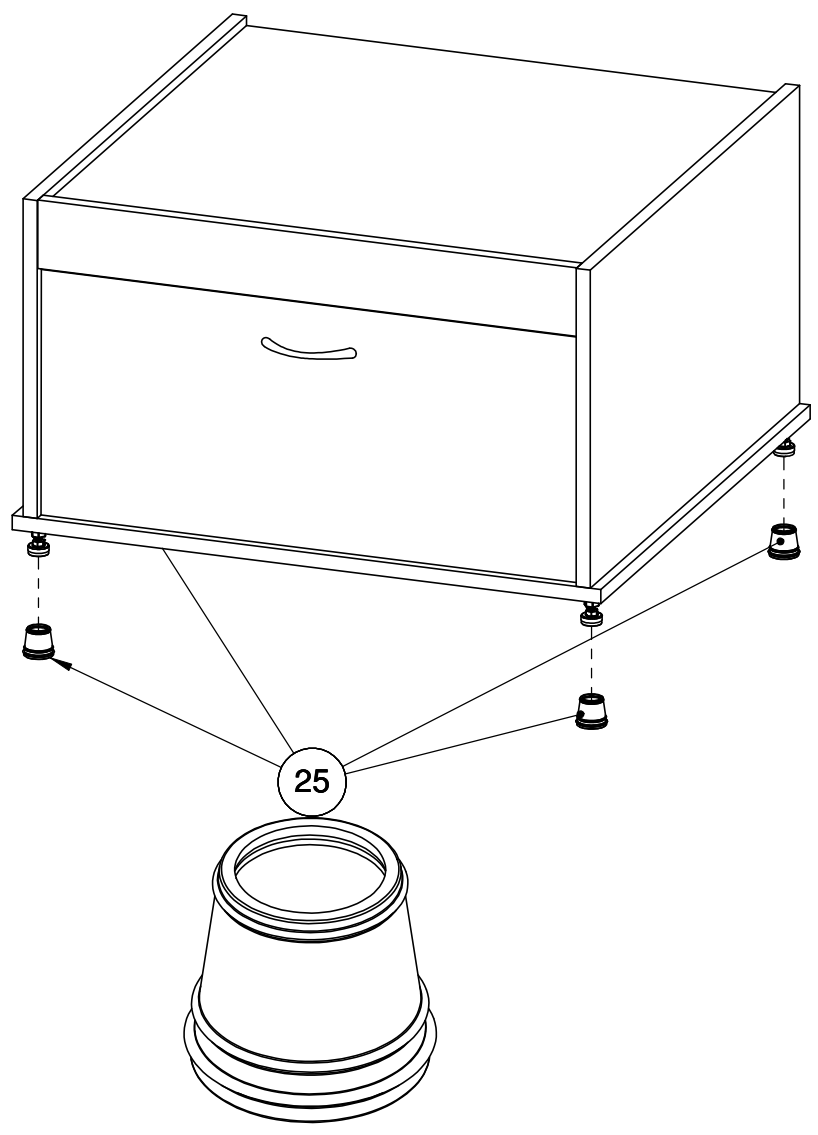

STEP 14
RECOMENDATION

To prevent water damage to the cabinet, it is recommended to apply Silicone to the three top edges of the unit (In case of water leak from the machine).

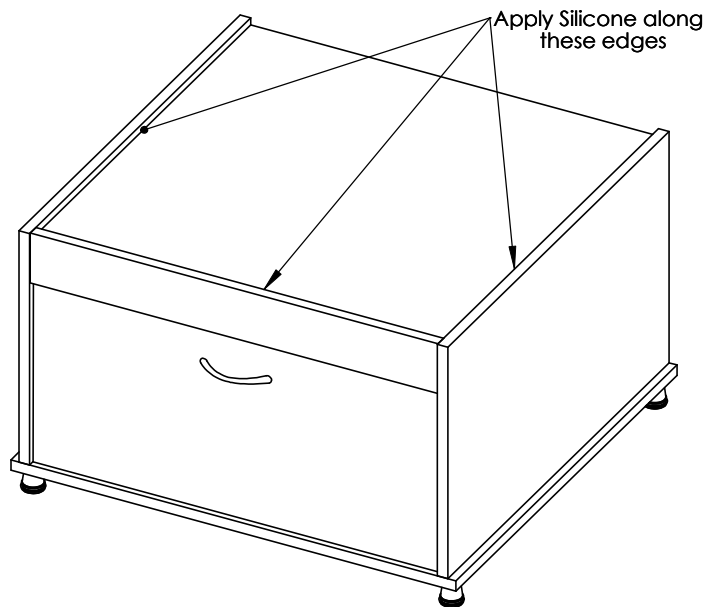
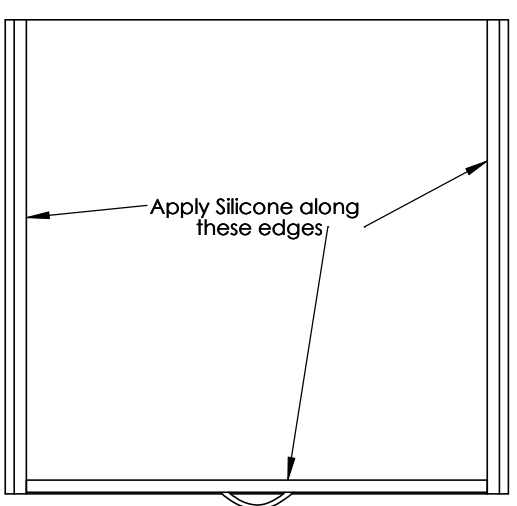



Bedford[™]
Furniture



Bedford Furniture Employee – Nick Fuller

Bedford Furniture is part of the Bedford Group. Bedford is a South Australian not-for-profit organisation dedicated to enhancing the lives of people with a disability or disadvantage through employment, training, residential services and life-skills.



Bedford[™]

615 Goodwood Road, Panorama SA 5041
PO Box 18 Melrose Park SA 5039

Telephone: 1800 822 823, Fax: (08) 8460 0009
Email: furniture@bedfordgroup.com.au

www.bedfordgroup.com.au